

Technique for Using the Show/Erase Dialog Box

The Show/Erase dialog box provides the ability to easily show or erase multiple types of detail items at one time. The Show/Erase dialog box also provides the ability to show only those items that have been previously erased, to show only those items that have never been shown, and to preview the drawing after making the desired selections. The following steps cover the suggested methods of utilizing this new functionality to obtain the desired display of items in a drawing.

Procedure

1. When clicking **View > Show and Erase**, the dialog box in Figure 1 displays. Selections for dimensions, reference dimensions, geometric tolerances, notes, balloons, axes, symbols, surface finishes, datums, cosmetic features, and datum targets appear and the **Show** button will be selected by default (or whatever the settings were when the dialog box was last used).

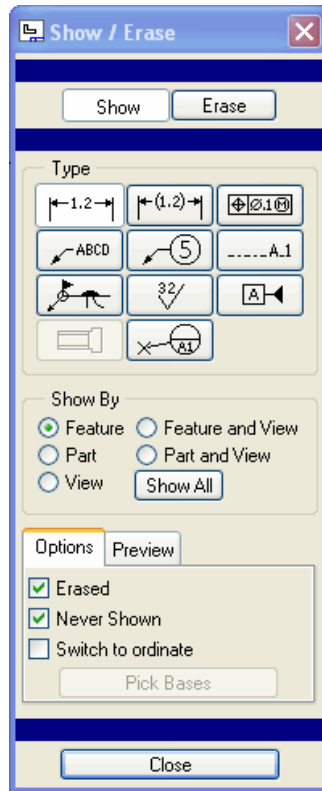

Once the icon for the detail item is selected, the constraints in the Show By portion of the dialog box become selectable. For example, if the length of the key feature should be shown in the lower right view, click the dimension button and then **Feature and View**. See Figure 2.

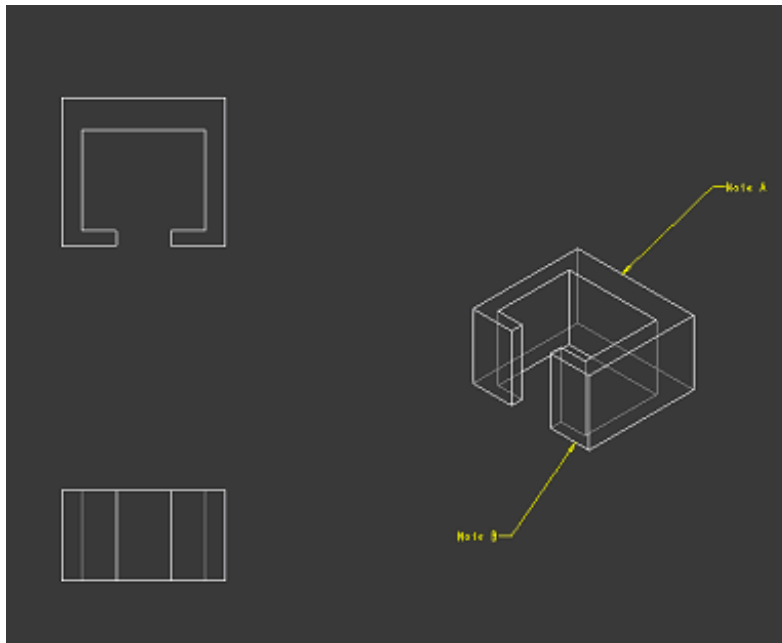

The user has the ability to preview the detail items which will be shown. To enable this functionality, click **With Preview** from the Preview tab. The dimensions to be shown are highlighted in cyan. See Figure 3.

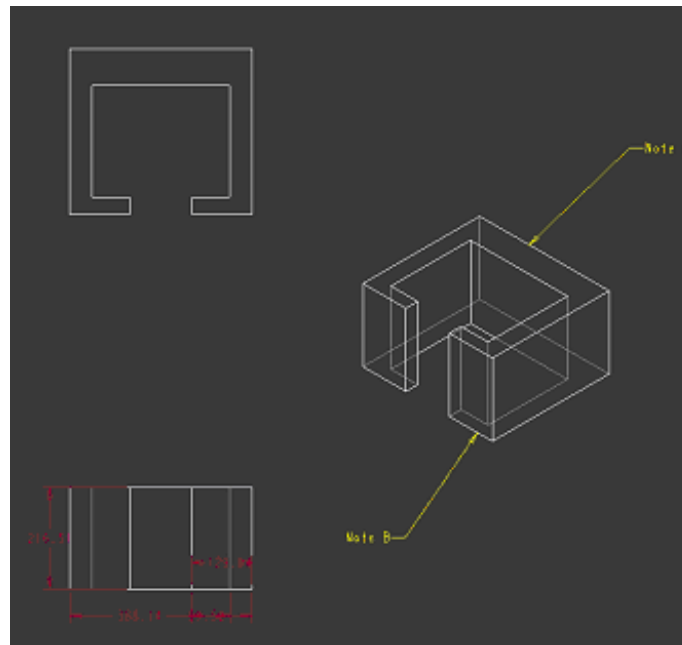

Once the key feature in the lower right view is picked, click **OK** or the middle mouse button to finish. The options **Accept All**, **Erase All**, **Sel To Keep**, and **Sel to Remove** become available. Click **Select to Keep**,

select the "388.14" dimension and click **Done Sel**. The config.pro option "show_preview_default" can be used to control whether **Sel to Keep** or **Sel to Remove** is the default. The valid values are "remove" and "keep".

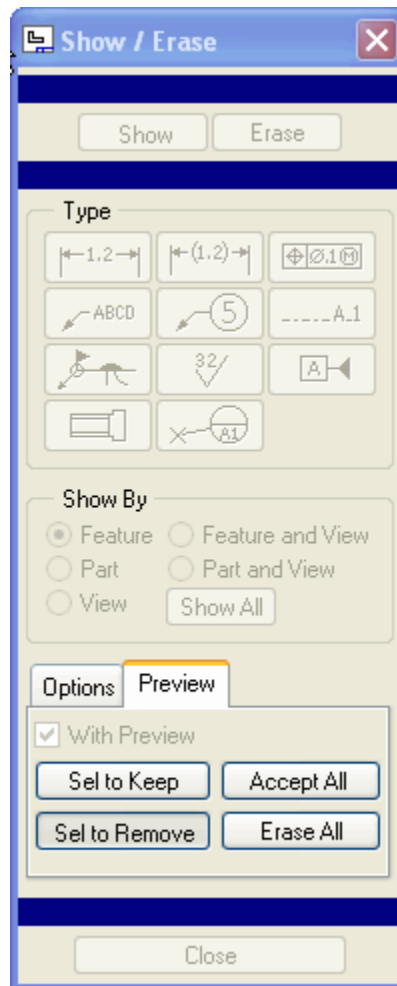

The selected dimension will display and all other previewed dimensions will be erased.

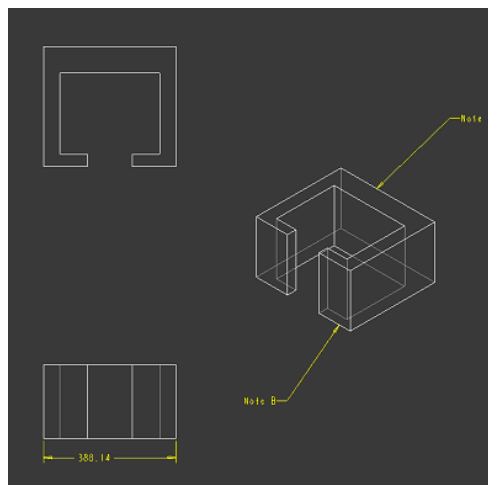

The Show/Erase dialog box can also be used for modifying the display of other entities. Another technique for using this dialog box involves the prevention of re-displaying items which have been explicitly erased at one time. The settings **Erased** and **Never Shown** in the Options portion of the dialog box control this ability. Figure 6 displays axes shown for the bolt plate model.

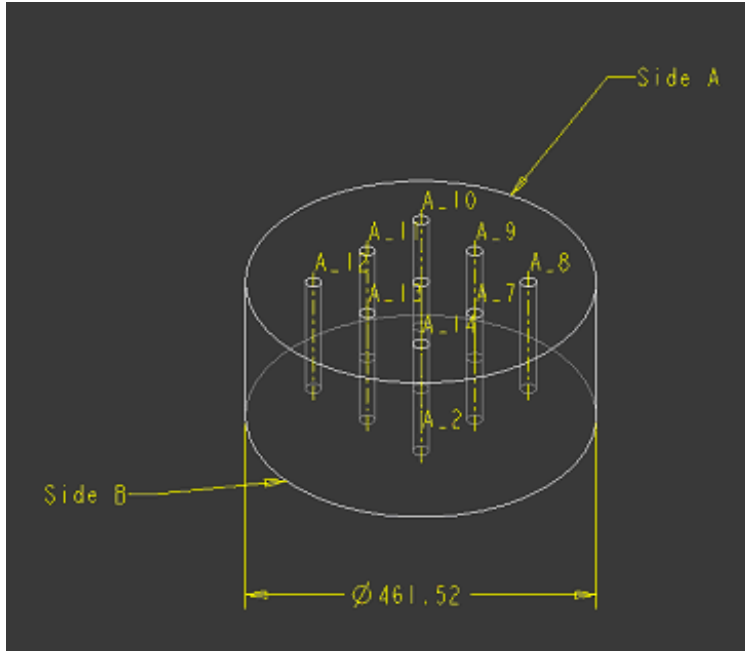

The axes can then be erased to finish detailing work. If axes were to be shown again and the **Erased** option was selected, only the axes which were previously shown and then erased would appear. If the **Never Shown** option is selected, the axes shown in the Step 6 would not appear. Only axes which had never been shown would appear. The **Never Shown** option prevents the user from having to re-erase items which have already been erased.

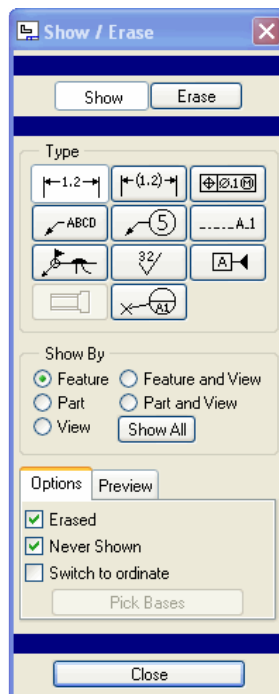

The last piece of functionality to be explained is the **Switch to ordinate** selection in the Options portion of the dialog box. This option will allow Pro/ENGINEER to automatically convert any unshown linear dimension to ordinate if an ordinate dimension baseline already exists which lines up with a witness line of any of the linear dimensions. When clicking **Switch to ordinate**, the **Pick Bases** button will be depressed. Select on an existing zero baseline in a view, click **Done Sel**, select the appropriate entity specified in the Show By portion of the dialog box (**Feature, Part, View**, etc.), and then select the feature, part, view, etc. Pro/ENGINEER will then convert any unshown linear dimensions to ordinate as long as they have a witness line which lines up with the existing baseline.
